

1 November 15, 1979

Introduced by: GARY GRANT
Proposed Ord. No.: 79-469

2
3
4
5
6
7
8 ORDINANCE NO. 4602

9
10 AN ORDINANCE amending King County Zoning
11 Resolution No. 25789, as amended, by amending
12 the Zoning Map thereof reclassifying certain
property thereon at the request of Newport
Hills Association, Inc., Building and Land
Development Division File No. 138-79-R.

13 BE IT ORDAINED BY THE COUNCIL OF KING COUNTY:

14 SECTION 1. Newport Hills Association, Inc. petitioned on
15 February 26, 1979, that the property described in Section 3
16 below be reclassified from RS 7200 to RM 900 and this application
17 was assigned Building and Land Development Division File
18 No. 138-79-R.

19 SECTION 2. The report and recommendation of the Building
20 and Land Development Division was transmitted to the Zoning and
21 Subdivision Examiner on May 10, 1979, and hearing was held by
22 the Examiner on the matter May 17, 1979. The report of the
23 Examiner was filed with the Clerk of the King County Council on
24 June 21, 1979, and the Council approved the reclassification by
25 Motion No. 4417 on August 13, 1979, subject to conditions which
26 will be satisfied per the "P" suffix.

27 SECTION 3. The legal description of the property to be re-
28 classified is attached as Appendix A and is hereby made a part
29 of this ordinance. The above described property is shown on the
30 attached map which is designated Appendix B and is hereby made
31 a part of this ordinance.

32 SECTION 4. The King County Council does hereby amend King
33

1 County Zoning Code, Resolution No. 25789, as amended, by reclassi-
2 fying that property described and shown in Section 3, Appendices
3 A and B above, to RM 900-P and directs that Area Map W 21-24-5
4 be modified to so designate.

5 SECTION 5. This reclassification is granted subject to condi-
6 tions adopted in Motion No. 4417 and said conditions are incor-
7 porated as though fully set forth herein.

8 INTRODUCED AND READ for the first time this 26th day
9 of November 1979.

10 PASSED this 26th day of November 1979.

11
12 KING COUNTY COUNCIL
KING COUNTY, WASHINGTON

13 Ruby Chow
14 Chairman

15 ATTEST:

16 Dorothy M. Owens DEPUTY
17 Clerk of the Council

18 APPROVED this _____ day of _____ 197 .

19 _____
King County Executive

20 DEEMED ENACTED WITHOUT
21 COUNTY EXECUTIVE'S SIGNATURE
22 DATED: 12/6/79

OVERALL LEGAL DESCRIPTION:

The Westerly 90 feet + of Lots 1, 2, and 3, Block 12, Newport Hills Addition No. 2 according to plat recorded in Volume 60 of Plats, page 88, records of King County, Washington. Section 21, Township 24 North, Range 5 East, Western Meridian. Less County roads.

Applicant: NEWPORT HILLS ASSOCIATION, INC.

FILE 138-79-R

Zone Change: RS 7200 to RM 900-P

APPENDIX B

STR: W 21-24-5

Proposed
Reclassification

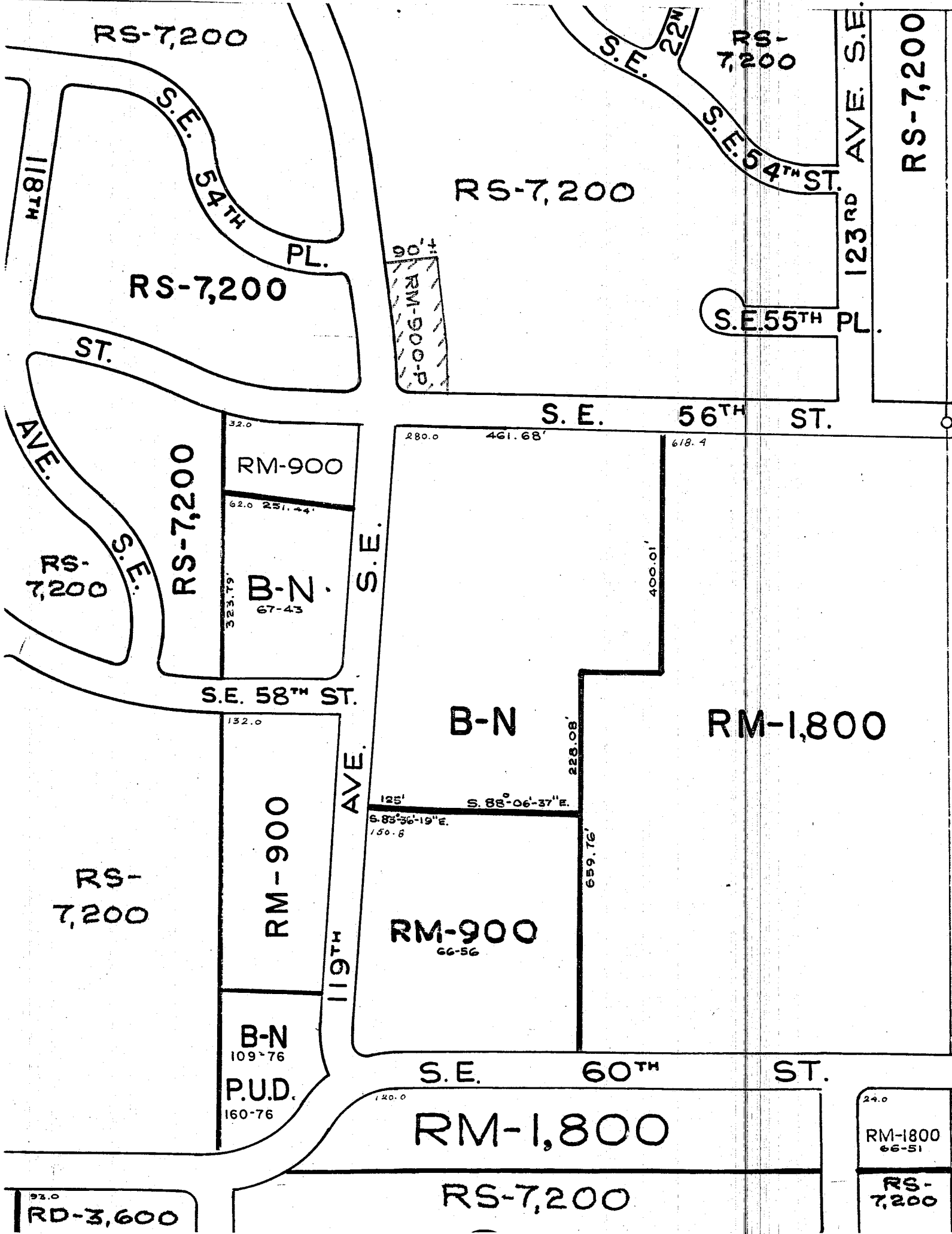
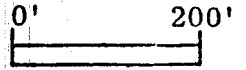

RS-7,200

RS-7,200

RS-7,200

RS-7,200

RS-7,200

RM-900

B-N
67-43

B-N

RM-1,800

RM-900
66-56

B-N
109-76

P.U.D.
160-76

RM-1,800

RM-1800
66-51

RD-3,600

RS-7,200

RS-7,200